

# 41005 Series Extended Size

## Extended size of Cage-Guided, Globe Valves with Lo-dB™, Anti-Cavitation Capabilities

### Excellent performance

**Masoneilan™ 41005 Series cage-guided control valves** from Baker Hughes provide highly dependable, field-proven performance for a variety of critical process control applications in industries such as power, onshore and offshore oil and gas, petrochemical, and refining. The valve's rugged design delivers excellent performance in extended sizes up to 36 inches.

### Low-emissions compliance

Addressing environmental concerns about fugitive emissions from industrial plants, Baker Hughes offers low-emissions packing options for all Masoneilan globe valve designs, including extended sizes up to 36 inches, meeting various global and regional requirements.

### Temperature Range

-29°C to +232°C (-20°F to 449°F)

### Valve Performance

- Class IV and V as per IEC 60534-4
- Fugitive Emission ISO 15848-1
- PED Directive 2014/68/EU
- Lifting lugs are provided
- Custom Trim Materials

### Materials of Construction

The extended size 41005 Series is available in the following body materials with appropriate trim and bolting options.

Carbon Steel WCC/WCB	Duplex Gr. 4A and 6A	Aluminium Bronze UNS C95800
Option Inconel Cladding	Other material available upon request	

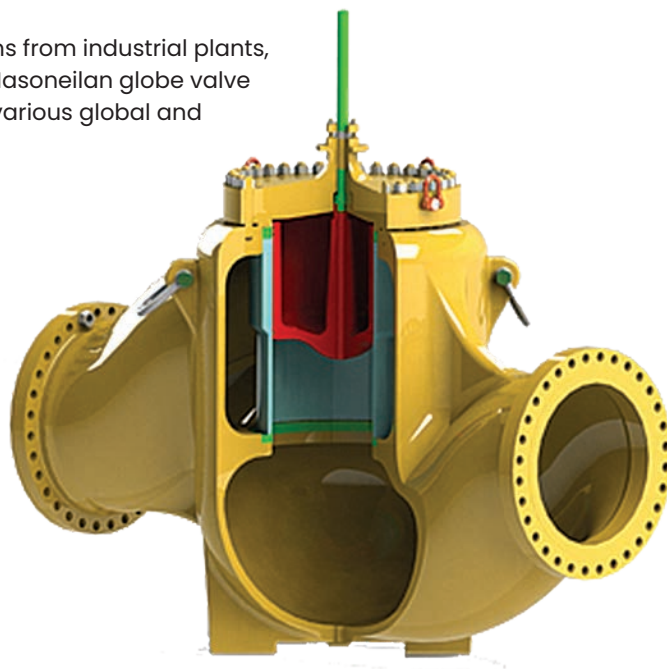

Ratings and Connections

Valve Size		ASME Class 150	ASME Class 300	ASME Class 600
inch	mm			
30	750	●	●	●
32	800	●	●	-
36	900	●	●	-

● Raised face flange

Trim Options

Available in linear flow characteristic with options for a ported cage, single stage Lo-dB and double stage anti-cavitation or characterized.

Plug is balanced with plug tip.



Single Stage  
Low Noise Trim FTO  
Anti-Cavitation Trim FTC



Multi-Stage  
Anti-Cavitation  
Trim FTC



Characterized Partial Lo-dB  
or anti-cavitation with  
ported trim

Capacity

A valve’s capacity for a liquid or gas to flow through it.

Defined as “the volume of water at 60°F (in US gallons) that will flow through a valve per minute with a pressure drop of one psi across the valve.”

		Max C <sub>v</sub>		
Valve Size		Linear Trim		
in	mm	Ported Cage	Single Cage	Double Stage Anti-Cavitation
30	750	10 500	8 000	-
32	800	13 100	9 300	8 000
36	900	17 000	13 000	11 500

Actuation

Masoneilan 51/52/53 Series pneumatic cylinder actuators provide high thrust and dynamic stiffness to meet a variety of throttling control and on/off applications.

Actuator Size	Stroke Length 51/52/53 Series						
	In	12	14	16	18	20	24
	mm	300	350	400	450	500	600
16L		●	●	●	●	●	●
20L		●	●	●	●	●	●
24L		●	●	●	●	●	●

## Actuator Control and Instrumentation

Masoneilan **SVI™** is a user-friendly digital valve positioner for pneumatic control valves. Utilizing advanced control and diagnostic algorithms, along with field-proven non-contact position sensing technology, the SVI delivers accurate, responsive, and reliable positioning performance.

Masoneilan offers a variety of valve instrumentation solutions suitable for a wide range of applications. The portfolio includes electro-pneumatic transducers, air filter regulators, booster relays and electric rotary switches.



## Dimensions - Flanged Valve

Valve Size		Dimension	ASME CL 150		ASME CL 300		ASME CL 600	
in	mm		in	mm	in	mm	in	mm
30	750	A	105.3	2 675	105.3	2 675	107	2 718
		B	42.9	1 090	42.9	1 090	41.7	1 052
		C	49.92	1 268	49.92	1 268	51.9	1 319
32	800	A	125	3 174	125	3 174	-	-
		B	39.37	1 000	39.37	1 000	-	-
		C	56.4	1 433	56.4	1 433	-	-
36	900	A	148.6	3 774	148.6	3 774	-	-
		B	45.67	1 160	45.67	1 160	-	-
		C	63.7	1 618	63.7	1 618	-	-

Note:

Values for B and C are shown as maximum and may vary with valve body and bonnet attributes. Certified drawings will provide specific dimensions.

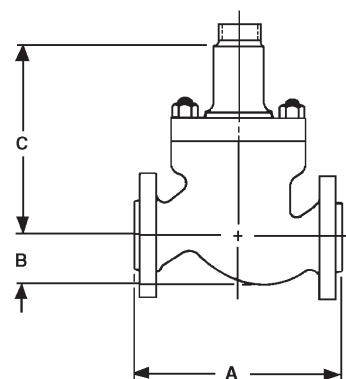

## Weights - Flanged Valve

Valve Size		ASME CL 150		ASME CL 300		ASME CL 600	
in	mm	lbs	kg	lbs	kg	lbs	kg
30	750	18 287	8 295	20 172	9 150	28 920	12 800
32	800	25 022	11 350	26 146	11 860	-	-
36	900	33 069	15 000	35 273	16 000	-	-

Note:

Weight values are maximum and may vary with valve body and bonnet attributes. Certified drawings will provide specific values.

Please consult your local Baker Hughes sales representative for more options and any additional product information.